

# MODULAR FILTERS

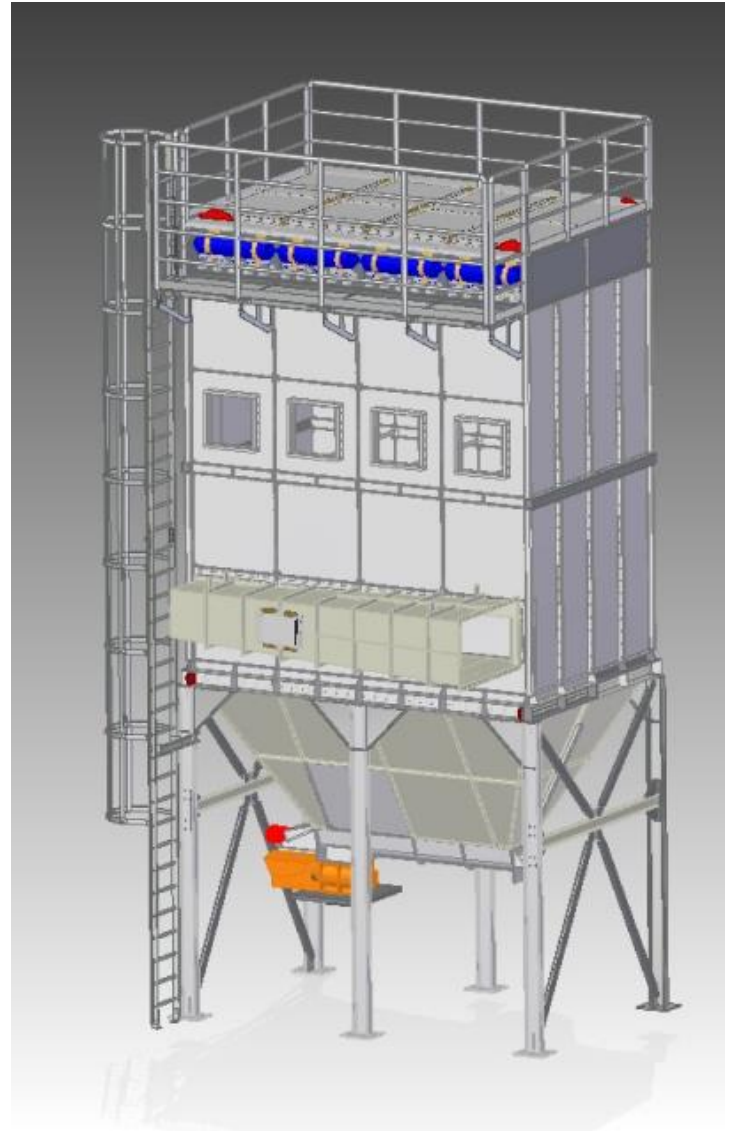

*Product & Design of  
Industrial Filters*

## LA Modular Filters

LA Modular Filters are designed for the separation of dust in various technological process and for local exhaustion.

### Description

The LA Modular Filter is divided into the chamber of cleaned air and the operating chamber, it is also manufactured as hermetic steel weld body.

Between the chamber of cleaning air and the operating chamber is creating a parting plane by a cubic sheet with holes for fastening the filter bags. The filter bags are fastened in the cubic sheet by stainless steel coupling. The bags are supported by cages, which are placed inside of them.

The dust separation proceeds in two phases, the larger and heavier particles are separated due to the dust breaker which is placed inside the operating chamber and leads into the hopper, the remaining particles are separated on the surface of the filter bags. Filter bag cleaning is carried out by short pulses of pressure air. The pulse-jet cleaning proceeds on the basis of the measured pressure loss, the so called grade of clogging, or in pre-set time intervals or in combination of both possibilities.

### Working conditions

The filters are designed for the separation of solid pollutants, contained in air and could be dangerous. By means of a suitable choice of filter bags and sealing materials the LA Modular Filters may operate up to temperatures of 220°C.

The filter chambers have been principally designed for underpressure of 5kPa.

The filters are designed to be able of installed indoor or outdoor. The electrical installation has been carried out to the protection grade of IP 54.

Filters used for higher temperatures or for higher pressures must be consulted with the manufacturer.

### Workmanship

The filters are delivered in the least possible transportable parts, the filter head and the hopper could be transported in one piece. The filters may be delivered with the supporting steel structure, or without it. The filters may be also delivered without a hopper, to place it directly onto a silo. If the filter delivered without a supporting steel structure, it is possible to deliver it with a hopper frame only, or with shoes, to place it on a supporting structure, supplied by the customer.

## Technical data

**Fig.1 Main parts of the filter**

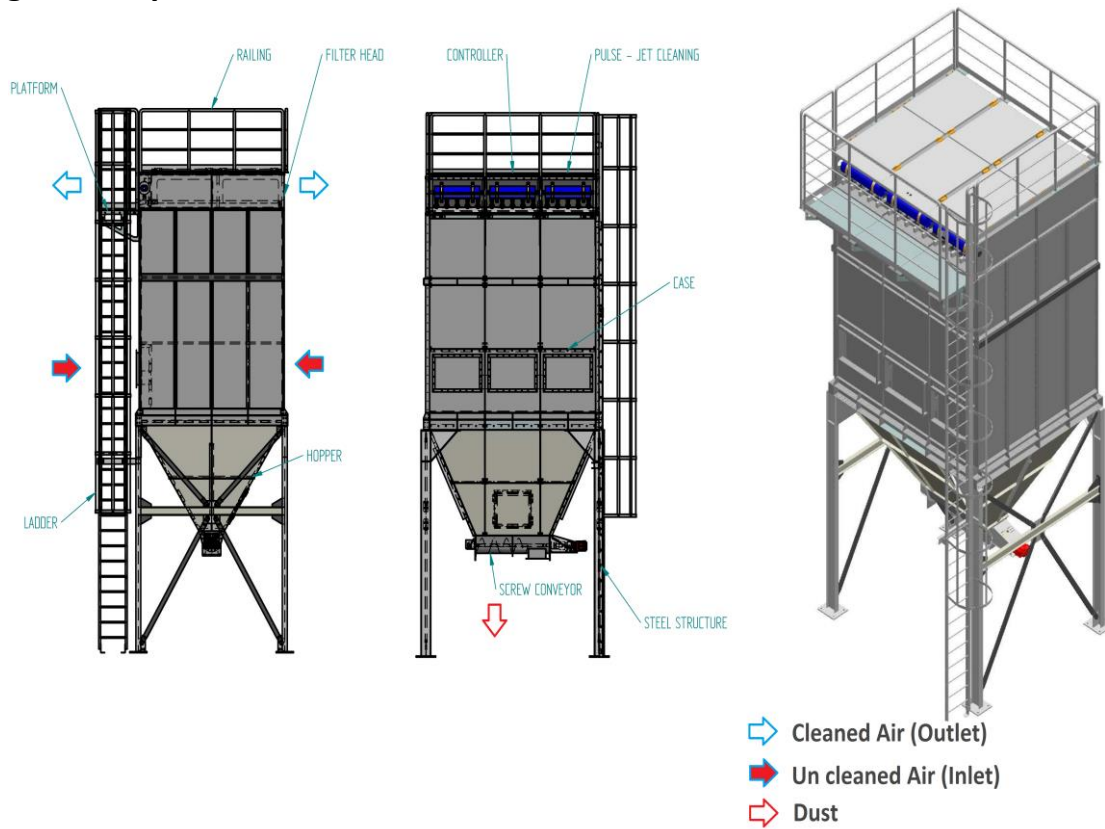

## Designation

LA 05-12-D\_3-W

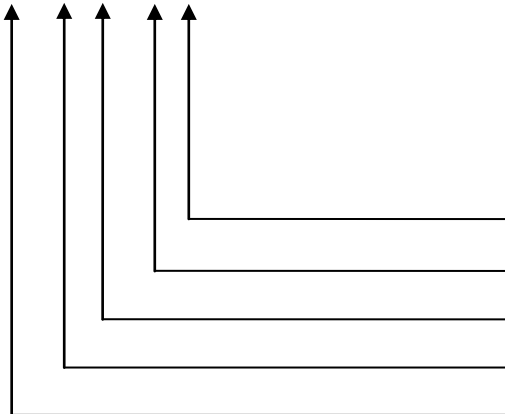

- Screw Conveyor
- Number of Modules
- Nominal length of Case
- No of filter bags per Valve
- No of Valves

## Basic Dimensions

**Fig.2 Filter LA in design B (without a Hopper)**

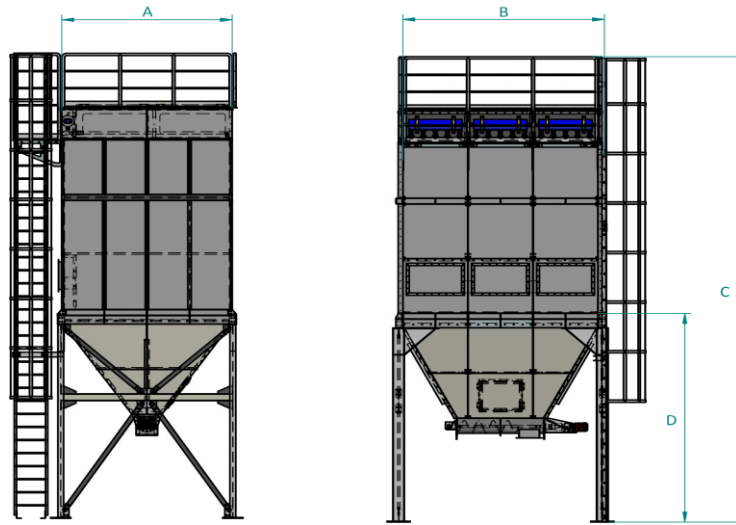

## Filter With Bags

Filter Type	A (mm)	B (mm)	C (mm)	D (mm)	Weight (KG)
05-12-B_1-W	2964	1125	8350	4320	2000
05-12-B_2-W	2964	2250	8350	4320	4400
05-12-B_3-W	2964	3375	8350	4320	6800
05-12-B_4-W	2964	4500	8350	4320	9200
05-12-B_5-W	2964	5625	8350	4320	11600
05-12-C_1-W	2964	1125	9475	4320	2200
05-12-C_2-W	2964	2250	9475	4320	4800
05-12-C_3-W	2964	3375	9475	4320	7400
05-12-C_4-W	2964	4500	9475	4320	10000
05-12-C_5-W	2964	5625	9475	4320	12600
05-12-D_1-W	2964	1125	10600	4320	2400
05-12-D_2-W	2964	2250	10600	4320	5200
05-12-D_3-W	2964	3375	10600	4320	8000
05-12-D_4-W	2964	4500	10600	4320	10800
05-12-D_5-W	2964	5625	10600	4320	13600

## Dust Outlet Flange

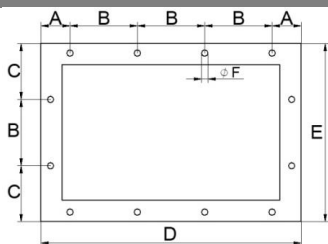

A (mm)	B (mm)	C (mm)	D (mm)	E (mm)	F (mm)
54,5	125	105,5	484	336	12

## Filter With Bags

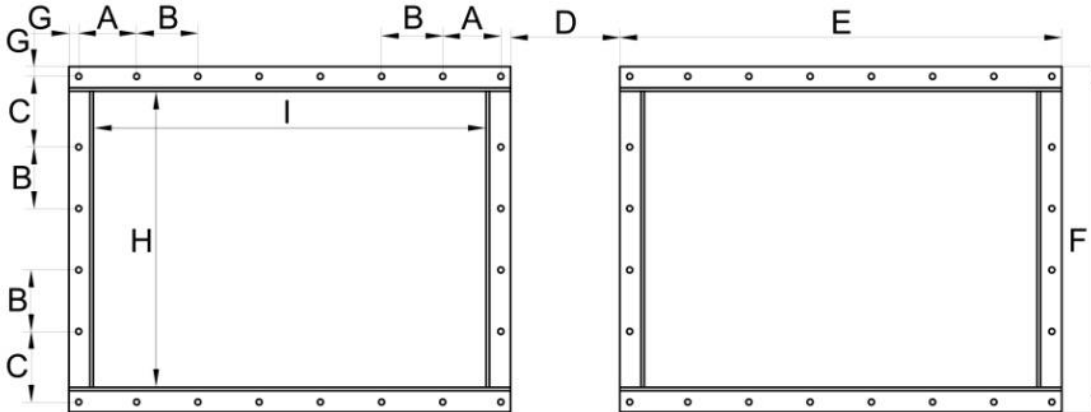

A	B	C	D	E	F	G	H	I
(mm)	(mm)	(mm)	(mm)	(mm)	(mm)	(mm)	(mm)	(mm)
118,5	125	143,5	223	902	702	20	602	802

## Air Outlet Flange

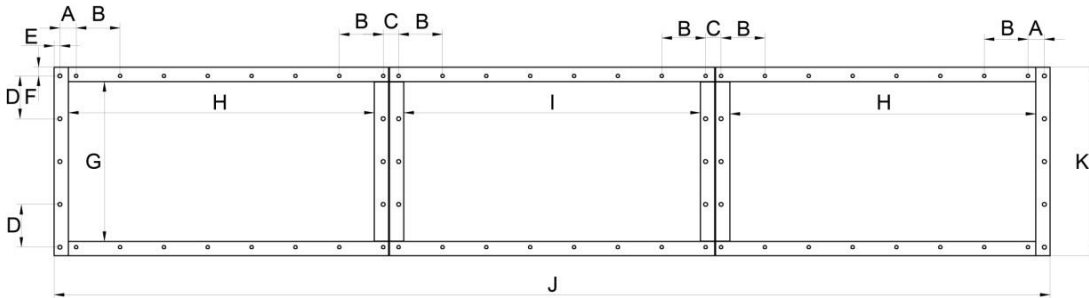

A	B	C	D	E	F	G	H	I	J	K
(mm)	(mm)	(mm)	(mm)	(mm)	(mm)	(mm)	(mm)	(mm)	(mm)	(mm)
57	153	54	150	20	30	560	1067	1035	3475	660

## Multiple Ways of Assembling

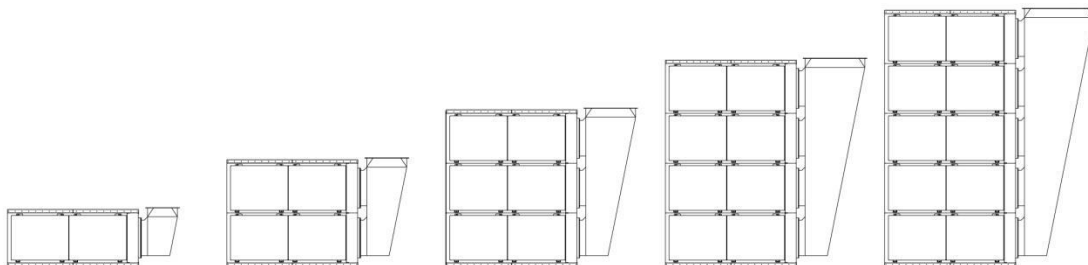

Alternative 1

Alternative 2

Alternative 3

Alternative 4

Alternative 5

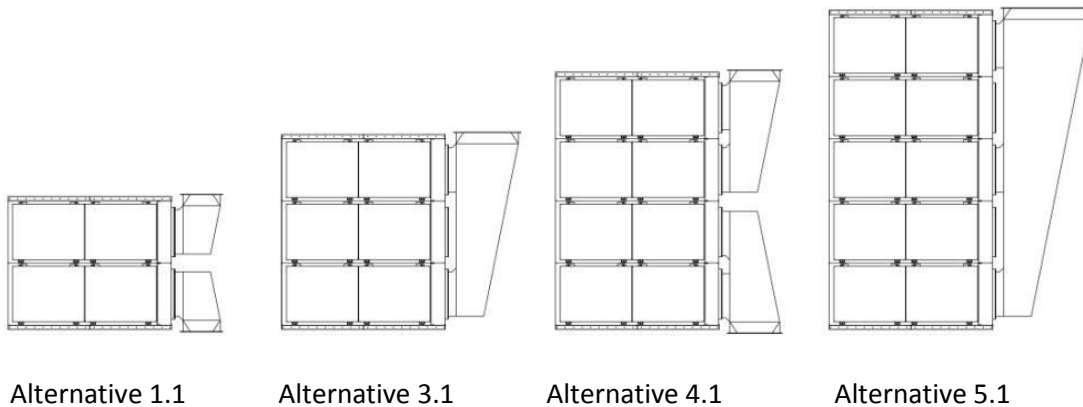

## Data for the Order

The size and the model of the filter must be consulted with the manufacturer. Based on exact technical specification the company Lasertech SA shell prepares the offer.

### **Especially the following must be stated in the offer:**

- Number of the offer.
- Filter type, according to the Designation paragraph
- Number of filter pieces.
- Position of the inlet flange\_ Left or Right.
- Position of the outlet flange\_ Left or Right.
- Requirement to deliver a filter for a silo\_ Without a hopper.
- Requirement for a non-standard height for the Steel Structure.
- For filters without Steel Structure the hopper type must be stated, with shoes or without shoes.
- Requirements for a possible enlargement of the discharge flange placed to the hopper, for pressure closure.
- Requirement for a possible increase of hoppers incline angle.
- Required delivery term.